

FEATURES & SPECIFICATIONS

INTENDED USE

Provides general illumination in hospitality, commercial and residential applications. Ideal for use in common areas, lobbies, foyers, hallways, corridors, living rooms, bedrooms, offices, restaurants, stairways and more.

CONSTRUCTION

The Autry Collection features an LED light source surrounded by a fabric-covered drum for a contemporary look. Available in any number of combinations, the Autry collection is made up of three sizes, six shapes and a variety of fabric designs. The small drum is suitable for ceiling mount or wall mount as a sconce.

OPTICS

Available in three different lumen packages, the square delivers between 600-1,600 lumens (determined by fabric/size selection).

ELECTRICAL

Fixture operates at 120 volts, 60Hz. Standard input = small, 9 watts; medium, 16 watts; large, 24 watts. Compatible with AC phase control dimmers.

Works with most standard incandescent dimmers (see list of approved dimmers).

INSTALLATION

All mounting hardware included for mounting to a standard junction box. The small drum is suitable for ceiling mount or wall mount. Medium and large sizes can be mounted flush to ceiling or to a variety of pendant options (see hanger options, page 2).

LISTINGS

UL Listed to US and Canadian standards and suitable for damp locations. † ENERGY STAR® certified. (ENERGY STAR certification is on LED pans FMPANL 6",11",14".)

WARRANTY — 5-year limited warranty. Complete warranty terms located at:

www.acuitybrands.com/support/warranty/terms-and-conditions

NOTE: Actual performance may differ as a result of end-user environment and application.

All values are design or typical values, measured under laboratory conditions at 25 °C.

Specifications subject to change without notice.

Catalog Number
Notes
Type

Decorative Indoor

Autry Collection LED Fabric Drum

SQUARE



White



Chocolate



Small

Specifications

	Small	Medium	Large
Diffuser			
Depth:	2.5 (6.4)	3.5 (8.9)	4 (10.2)
Length/Width:	7.4 (18.8)	12.25 (31.1)	15 (38.1)
Weight:	.66 (.3)	1.24 (.6)	01.52 (.7)
LED Pan			
Diameter:	6 (15.2)	11 (28)	14 (35.6)
Weight:	.48 (1.2)	1.75 (4.5)	2.6 (6.6)

All dimensions are inches (centimeters) unless otherwise indicated.

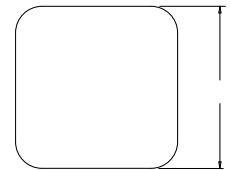

ORDERING INFORMATION

For shortest lead times, configure product using **bolded options**.

Example: DFMASQL 11 F01

Series ^{1,2}	Size	Finish
DFMASQL Autry LED fabric square diffuser	6 Small ³ 11 Medium 14 Large	F01 White F02 Chocolate F23 Jute F24 Rapids

ORDERING INFORMATION

For shortest lead times, configure product using **bolded options**.

Example: FMPANL 11 14830

Series	Module/CRI	Color temperature
FMPANL 6 † Small Autry LED pan ³	78 >80	40 4000 K 35 3500 K ⁴ 30 3000 K 27 2700 K ⁴
FMPANL 11 † Medium Autry LED pan	148 >80	
FMPANL 14 † Large Autry LED pan	208 >80	

† Only these configurations are ENERGY STAR certified.



Small LED pan

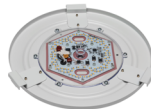

Medium LED pan

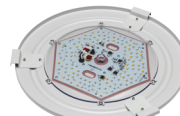

Large LED pan

Notes

- 1 Order LED pan separately.
- 2 Limited stock availability on diffusers.
- 3 Small LED pan can be ceiling or wall mounted. Surface mount only.
- 4 Minimum 90-day lead time for non-standard color temperatures; minimum 50 order quantity.
- 5 Small square not available with fabric finish.

LED Flush Mount Autry Collection

PHOTOMETRICS

Photometric data report available within 2 weeks from request. Consult factory. Photometric data not available on all size/fabric finish selections.

HANGER OPTIONS

See separate spec sheet at www.acuitybrands.com/led-flush-mount-hangers.



ADDITIONAL INFORMATION

SUGGESTED DIMMERS

The Autry Collection is designed to operate with most standard Triac Based dimmers and is not compatible with 0-10v dimming systems. The following is a list of dimmers tested and does not imply any guarantee or warranty of compatibility with a particular application. Unlisted dimmers do not imply non-compatibility.

Manufacturer	Part number(s)	Manufacturer	Part number(s)
Leviton	6633P	Lutron	DVELV 300P
	IPL06		SkyLark 300P
	6674P		NTELV 300
	IPE04		NLV 600
	Trimatron 600W	Synergy	ISD 600 I 120